

Wooden Flat Pack Display Plinth Podium - Instructions

STEP 1.

Lay one panel with black clips on the ground, now select one panel with green clips and whilst keeping it at a 90-degree angle with the floor, clip in the clasps.

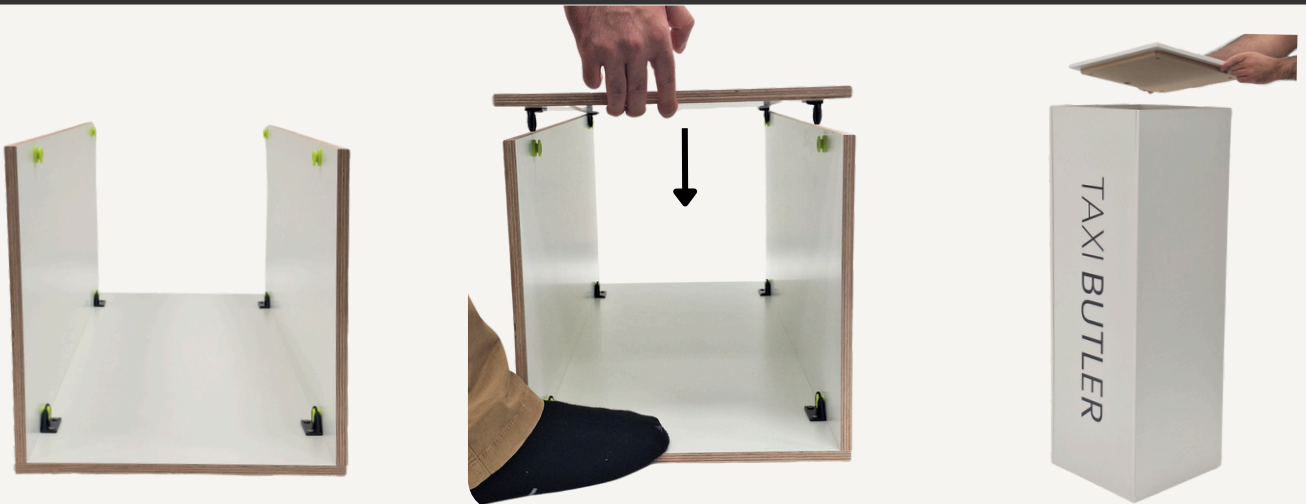
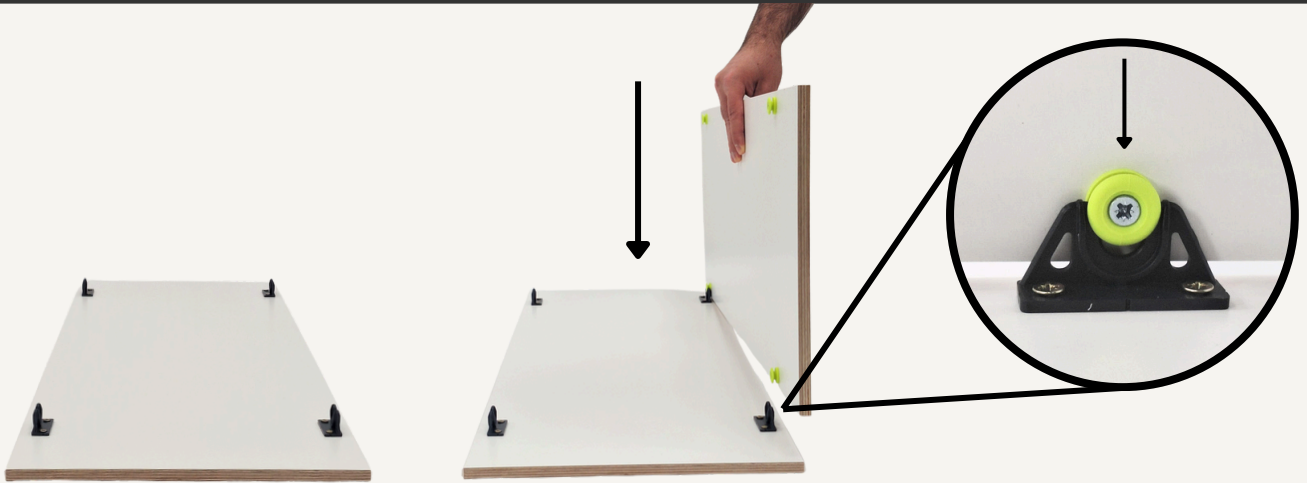

STEP 2.

Whilst supporting the already secured panel, clip in the alternate panel.

STEP 3.

Continuing to support the secured panels, clip in the final black clip top panel.

STEP 4.

Finally, stand the unit upright and slot the lid on top.